



SPECIFICATIONS

CPU	Intel® Core™ i7-13700 Intel® Core™ i5-13400 Intel® Core™ i3-13100
İşletim Sistemi	Windows 11 Home Windows 11 Pro - MSI recommends Windows 11 Pro for business
Audio Speaker	2x 3W
Yongaseti	Intel® H610
I/O	1x USB 3.2 Gen 2 Type C 1x USB 3.2 Gen 2 Type A 2x USB 3.2 Gen 1 Type A 2x USB 2.0 Type A 1x RJ45 1x HDMI™ out (2.0b) 1x DP out (1.4) 1x Mic-in 1x Line-out
Bellek	2x DDR4 3200MHz SO-DIMMs, up to 64GB
Grafik	Intel® UHD Graphics
LAN	Realtek RTL8111H
Panel Çözünürlüğü	27" IPS Grade Panel LED Backlight (1920*1080 FHD) with MSI Anti-Flicker technology
Dokunmatik Panel	Non-touch
Ses	Realtek ALC897
Kablosuz LAN	Intel Wi-Fi 6E AX211 Intel WWi-Fi 6 AX201 Intel Wireless AC 3168 (either one)
Storage	1x M.2 SSD (auto switch) 1x 2.5" HDD / SSD
Bluetooth	5.3 (for AX211) / 5.2 (for AX201) / 4.2 (for AC 3168)
Web Kamera	Built-in FHD Webcam which supports Windows Hello Removable webcam cover design
Klavye / Fare	Optional
AC Adaptörü	120W
Brüt Ağırlık	8 kg (17.64 lbs)
Adjustment (Tilt)	-5° ~ 20°

FEATURES



Anti-Flicker technology

MSI Anti-Flicker technology provides a very comfortable viewing experience by reducing the amount of screen flicker.



Less Blue Light

Effectively reduce blue light which could cause serious long-term damage to your eyes.



Anti-Glare Display Design

An anti-glare display makes viewing the display more pleasant for users and reduces eyestrain for users



MSI Center

The MSI Center takes optimization to the next level with easily adjustable system modes and resources for a wide range of scenarios and needs.



Silent PRO Colling

3 independent chambers with exclusive thermal module provide the best solution while rendering, editing and multitasking



TPM Support

FW TPM design secures your confidential data with encryption keys.



Tool Less Design

Assemble and disassemble the stand without any tools needed.



IPS Grade Panel

Instantly optimize the screen colors and brightness to ensure that you enjoy every detail at its best while creating your own on-line video



MSI Center

The MSI Center takes optimization to the next level with easily adjustable system modes and resources for a wide range of scenarios and needs.

CONNECTIONS

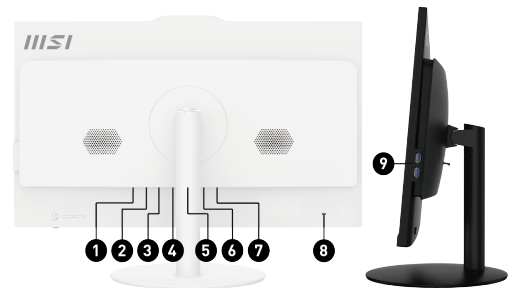

- | | |
|---|----------------------------|
| 1. DC Jack | 2. 1x HDMI™ out (2.0b) |
| 3. 1x DP out (1.4) | 4. 1x RJ45 |
| 5. 1x USB 3.2 Gen 2 Type-A/ 1x USB 3.2 Gen 2 Type-C | 6. 2x USB 3.2 Gen 1 Type A |
| 7. 1x Mic-in/ 1x Line-out | 8. 1x Kensington lock |
| 9. 2x USB 2.0 Type-A | |

MANAGEMENT UTILITY	MSI Center: Hardware Monitoring, Free Up Memory, Clean Up Disk, MSI Recovery, F3 Recovery, Devices Speed Up, Smart Priority, Smart Image Finder, Noise Cancellation, Live Update, Microsoft App Update, System Info, Troubleshooting, Contact Us, MSI Forum & Channel MSI Display Kit: Split Window, Display Setting (Orientation, resolution, refresh rate, size of text and app), Display Color Setting (Customizable Link App: Eye Saver Mode, Personal setting, Standard, Gaming, FPS, RTS/RPG, Cinema), Connect to wireless display, On-screen keyboard, Mouse Sensitivity, Power setting, Magnifier (Zoom in / Zoom out), Project way setting (internal/ Clone/ Extend/ External)
SECURITY UTILITY & DEVICE	MSI Center: System Diagnosis, Tile (Find My Device) Tobii Aware: - Security and Privacy: Privacy Screen/ Auto Lock/ Peeker Detection - Dim Screen: Energy saving - Windows Snap - TPM 2.0 Support
Net Weight	4.63 kg (10.21lbs)
Certificates	FCC, CB/CE, UL & CUL, VCCI, RCM
Note	Support VESA wall mount kit with specific screws, please contact with service center.