



## SPECIFICATIONS

<b>MODEL NAME</b>	MPG GUNGNIR 100
<b>Front I/O Ports</b>	2 x USB 3.0 + HD Audio / Mic
<b>Drive Bays</b>	2 x 3.5" (compatible with 2.5" ) + 4 x 2.5"
<b>VGA Card Support</b>	Max 400mm / 15.75 inch
<b>CPU Cooler Support</b>	Max 170mm / 6.69 inch
<b>Power Supply</b>	Standard ATX
<b>WEIGHT (CARD)</b>	169g
<b>Radiator Compatibility</b>	120 / 140 / 240 mm
<b>Chipset</b>	Intel® H610
<b>Case Form Factor</b>	Mid-Tower
<b>Wireless LAN</b>	Intel® Wi-Fi 6E AX210
<b>Bluetooth</b>	5.3
<b>AC ADAPTER / PSU</b>	500W Bronze 80 Plus (ATX)
<b>Dimensions</b>	120mm x 120mm x 25.6mm
<b>Bearing Type</b>	Hydro-Dynamic Bearing
<b>Cooling System</b>	Air Cooler
<b>Rated Speed</b>	500 - 1800 ±15% RPM
<b>I/O (Rear)</b>	2x USB 3.2 Gen 1 Type A 4x USB 2.0 Type A 1x PS/2 Combo port 1x VGA (D-sub) 1x Support 4K@60Hz as specified in DisplayPort 1.4 port 1x Support 4K@60Hz as specified in HDMI™ 2.1 with HDR port. 1x RJ45 (1G LAN) 3x Audio jacks 2x Wi-Fi Antenna
<b>Weight (N.W. / G.W.)</b>	7.73 kg / 10.44 kg
<b>Air Flow</b>	19.79 - 71.27 CFM
<b>Carton Dimension (WxDxH)</b>	585 x 317 x 510 mm
<b>Static Air Pressure</b>	0.16 - 2.09 mm-H2O
<b>Connector</b>	4-Pin PWM/DC
<b>Life Expectancy</b>	MTTF 150,000 Hours (25°C)
<b>Radiator Size Support</b>	Front: 120 / 140 / 240 / 280 / 360 mm Top: 120 / 140 / 240 / 280 / 360 mm Rear: 120 / 140 mm Side: 120 / 240 / 360 mm
<b>PRODUCT DIMENSIONS (MM)</b>	510(D) x 227(W) x 525(H) mm 20.08(D) x 8.94(W) x 20.67(H) inch
<b>Net Weight</b>	15.95 kg / 35.16 lbs
<b>Gross Weight</b>	21.55 kg / 47.51 lbs

## FEATURES



### Intel 13th Gen Processors

Equipped with 13th Gen Intel® Core™ i7 processor.



### GeForce RTX™ 40 series GPUs (AI accelerator)

Built with MSI GeForce RTX™ Graphics Cards, offering up to 4 times gaming performance and 1.8 times AI performance.



### Customizable Tempered Glass Panel Design

Looking for some versatility on the style of your gaming PC? You are in the right place.

### Mystic Light



Make your build look on fire or cold as ice. You are in control. Customize colors and effects with RGB LED.

### NVMe PCI-E M.2 SSD



Unleash the full performance potential of the latest SSD technology with support up to NVMe SSD read speeds.

### Wi-Fi 6E



The latest WiFi 6E delivers stunning speed while keeps the network smooth and stable even when sharing the network with numerous users.

## CONNECTIONS

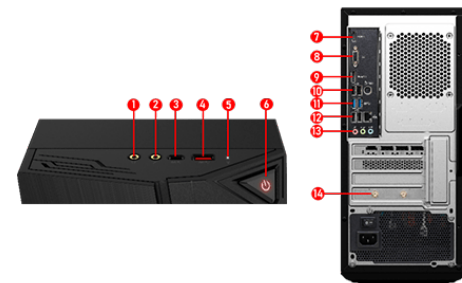

- |                            |                                            |
|----------------------------|--------------------------------------------|
| 1. 1x Headphone            | 7. 1x HDMI™ out                            |
| 2. 1x Microphone           | 8. 1x VGA (D-sub)                          |
| 3. 1x USB 3.2 Gen 1 Type C | 9. 1x DisplayPort out                      |
| 4. 1x USB 3.2 Gen 1 Type A | 10. 1x PS/2 Combo port / 2x USB 2.0 Type A |
| 5. HDD LED                 | 11. 2x USB 3.2 Gen 1 Type A                |
| 6. Power button            | 12. 1x RJ45 (1G LAN) / 2x USB 2.0 Type A   |
| 7. 1x HDMI™ out            | 13. 3x Audio jacks                         |
| 8. 1x VGA (D-sub)          | 14. 2x Wi-Fi Antenna                       |

**Note**

Material: Left Side: Tempered Glass/ Right  
Side- Metal  
Vertical GPU Mount : Yes  
Touch Panel: Yes