

[How To] Setup Wireless Display/Miracast

This document shows the requirements of Miracast/wireless display support and step-by-step setup instructions.

Requirements

- Windows 8.1 or newer version.
MSI laptops that are pre-installed with Windows 11 or Windows 10 system support Miracast by default. (Self-installed Windows system can run the DirectX tool to check for Miracast support refer to [steps](#) below)
- A screen with built-in Miracast support or connected with an external Miracast dongle.
*Notes: Not all smart TVs have Miracast built-in. It's recommended to confirm with the monitor manufacturer if the product supports Miracast.

Setup Wireless Display/Miracast

1. Make sure the laptop and the wireless monitor are connected to the same Wi-Fi network.

Note: It's recommended to use 5GHz band for better connection quality.

2. Press [Win] + [K] and select the wireless display from the list.

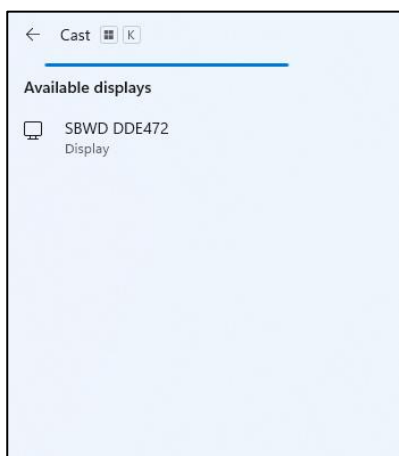

3. When the connection is established successfully, select the display mode according to the requirements.

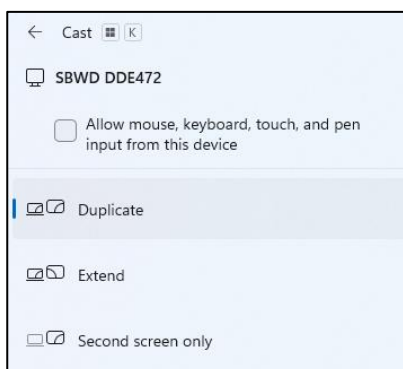

Appendix.

1. Press [Win] + [R] and type “dxdiag”, then click on “OK”.
2. Click on “Yes” to check if the drivers are digitally signed.

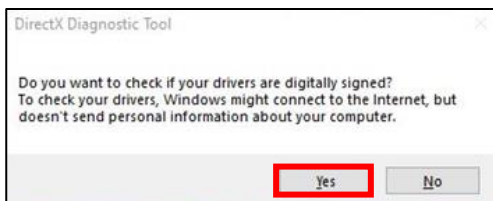

3. Select “Save All Information” and save the text file to the desired directory.

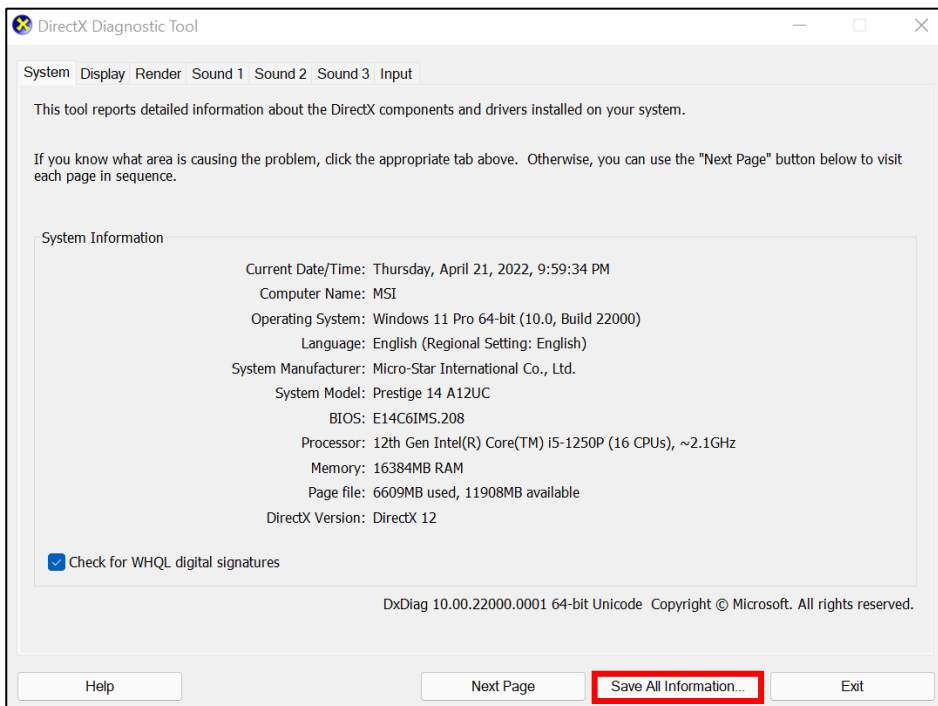

4. Open the saved “DxDiag.txt” file and make sure “Miracast” is available.

