

Be Your Window To The World



Picture and logos

SELLING POINTS

- Windows 11 Home - MSI recomienda Windows 11 Pro para empresas
- Con procesadores Intel Alder Lake
- Admite pantalla 4K UHD
- Admite hasta tres pantallas que te permiten ver más y hacer más
- Solución de red dual para Internet e Intranet
- Disfruta de todas las ventajas de rendimiento del USB 3.2 Gen 2 y disfruta de la mejor experiencia de transmisión de datos
- El diseño dTPM 2.0 protege tus datos confidenciales con claves de cifrado
- Admite montaje VESA estándar
- Compatible con MSI Cloud Center y la aplicación MSI Center

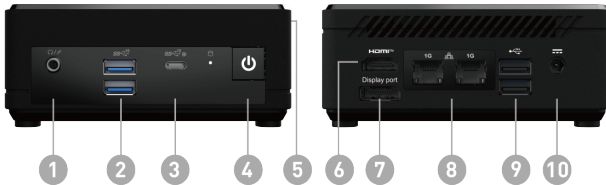

1. 1x Mic-in/ Headphone-out combo
2. 2x USB 3.2 Gen 2 Type A
3. 1x USB 3.2 Gen 2 Type C (DP Alternate)
4. 1x Power Button
5. 1x Kensington Lock
6. 1x HDMI™ (2.1)
7. 1x DP-out (1.4)
8. 2x RJ45 (LAN)
9. 2x USB 2.0 Type A
10. DC Jack

SPECIFICATION

Sistema operativo	OS	N/A
	Operating Systems	N/A
Modelo	Part No	936-B0A911-001
	MKT Name	Cubi N ADL
	MKT Spec	Cubi N ADL-001BEU
	Color	ID1/Black-Black-Black
Chipset	Chipsets	Soc
Memoria	Memory Size	N/A
	Memory Type	N/A
	Memory Speed	N/A
	Module Type	SO-DIMM
	Memory Slot(Total)	1
	Memory Slot(Free)	1
	Max Capacity	Max 16GB
Procesador	CPU Number	Intel Processor N200
	CPU Clock	1GHz
	CPU Cores	4
	TDP	6W
	Max Turbo Frequency	up to 3.70 GHz
	Cache	6 MB
	Threads	4
Gráficos	GPU1 Vendor	N/A
	GPU1 MKT Name	N/A
	GPU1 Number	N/A
	GPU1 VRAM Size	N/A
Audio	Audio Chipset	Realtek ALC256
	Audio Type	2.1 Channel HD Audio
Almacenamiento	SSD Interface	N/A
	SSD Form Factor	N/A
	SSD Config	N/A
	SSD Size	N/A
	HDD1 Interface	N/A
	HDD1 Form Factor	N/A
	HDD1 Size	N/A
	HDD1 RPM	N/A
	ODD(Type)	N/A
	ODD Height	N/A
	ODD Type	N/A
	mSATA slots(Free)	0
	M.2 slots(Total)	1
	M.2 slots(Free)	1
	2.5" Drive Bays(Total)	1
	2.5" Drive Bays (Free)	1
3.5" Drive Bays(Free)	0	
Comunicaciones	LAN	2x Realtek RTL8111H
	WLAN Version	802.11ac 1x1+BT
	BT Version	4.2
Puertos de E/S (laterales)	USB 3.2 Gen 2 Type C	1x USB 3.2 Gen 2 Type C (DisplayPort Alternate)
	USB 3.2 Gen 2 Type A	2
Puertos de E/S (frontal)	Mic-in/Headphone-out combo	1
	USB 3.2 Gen 2 (10G) Type C	1x USB 3.2 Gen 2 Type C (DisplayPort Alternate)
	USB 3.2 Gen 2 (10G) Type A	2
Puertos de E/S (Traseros)	USB 2.0 Type A (R)	2
	RJ45	2
	HDMI out	1x (v2.1)
	DP out	1x (v1.4)
Garantía	Warranty	24months

Dimensiones y peso	Weight (Net kg)	0.54
	Weight (Gross kg)	1.39
	Product Dimension (WxDxH) (mm)	124 x 124 x 53.7
	Product Dimension (WxDxH) (inch)	4.88 x 4.88 x 2.11
	Inside Carton Dimension (WxDxH) (mm)	205 x 220 x 94
	Inside Carton Dimension (WxDxH) (inch)	8.07 x 8.66 x 3.7
	Net Weight (lbs)	1.19
	Gross Weight (lbs)	3.06
VESA	VESA size	100 x 100 mm
Mecánica y medio ambiente	Regulatory Compliance	FCC(Class B), CB/CE, UL(CUL), BSMI, VCCI, RCM(C-Tick)
Accesorios	AC Adaptor	1
	Power Cord	1
	Warranty Card	N/A
	Quick Guide	2
	User Manual	N/A
	VESA Mount kit	1
	Keyboard	N/A
	Keyboard Interface	N/A
	Mouse	N/A
Mouse Interface	N/A	
Información sobre el código de barras	EAN	4711377069489