

Be Your Window To The World



Picture and logos

SELLING POINTS

- Windows 11 Home - MSI recomienda Windows 11 Pro para empresas
- Con procesadores Intel Alder Lake
- Admite pantalla 4K UHD
- Admite hasta tres pantallas que te permiten ver más y hacer más
- Solución de red dual para Internet e Intranet
- Disfruta de todas las ventajas de rendimiento del USB 3.2 Gen 2 y disfruta de la mejor experiencia de transmisión de datos
- El diseño dTPM 2.0 protege tus datos confidenciales con claves de cifrado
- Admite montaje VESA estándar
- Compatible con MSI Cloud Center y la aplicación MSI Center

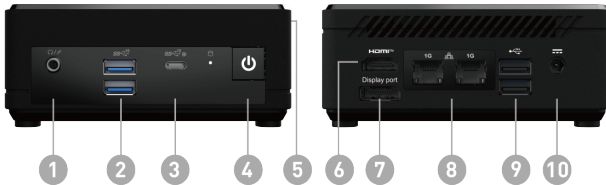

1. 1x Mic-in/ Headphone-out combo
2. 2x USB 3.2 Gen 2 Type A
3. 1x USB 3.2 Gen 2 Type C (DP Alternate)
4. 1x Power Botton
5. 1x Kensington Lock
6. 1x HDMI™ (2.1)
7. 1x DP-out (1.4)
8. 2x RJ45 (LAN)
9. 2x USB 2.0 Type A
10. DC Jack

SPECIFICATION

Operating Systems	Operating Systems	N/A
Model	Part No	936-B0A911-031
	MKT Name	Cubi N ADL
	MKT Spec	Cubi N ADL-009BEU
	Color	ID1/Black-Black-Black
Processor	CPU Number	Intel Processor N100
	CPU Clock	0.8GHz
	CPU Cores	4
	TDP	6W
	Cache	6 MB
	Threads	4
	CPU Cooler	Air cooling
Chipset	Chipsets	Soc
Memory	Memory Size	N/A
	Memory Type	N/A
	Memory Speed	N/A
	Module Type	SO-DIMM
	Memory Slot (Total/Free)	1/1
	Max Capacity	Max 16GB
Discrete Graphics	VGA I/O Port	N/A
	VGA MKT Name	N/A
	GPU1 VRAM Size	N/A
Storage	SSD Size	N/A
	HDD1 Size	N/A
	SSD Config	N/A
	SSD Interface	N/A
	SSD Form Factor	N/A
	M.2 slots (Total/Free)	1/1
	HDD1 RPM	N/A
	HDD1 Form Factor	N/A
	HDD1 Interface	N/A
	3.5" Drive Bays (Total/Free)	0/
	2.5" Drive Bays (Total/Free)	1/1
	ODD(Type)	N/A
	ODD Height	N/A
ODD Type	N/A	
Communications	LAN	2x Realtek RTL8111H
	WLAN	INTEL/9462.NG.WG.NV
	WLAN Version	802.11ac 1x1+BT
	BT Version	5
Audio	Audio Chipset	Realtek ALC256
	Audio Type	2.1 Channel HD Audio
I/O Ports (Front)	USB 3.2 Gen 2 Type A	2
	USB 3.2 Gen 2 Type C	1x USB 3.2 Gen 2 Type C (DisplayPort Alternate)
	Mic-in/Headphone-out combo	1
I/O Ports (Rear)	USB 2.0 Type A (R)	2
	RJ45	2
	HDMI™ out	1x (v2.1)
	DP out	1x (v1.4)
Power	Power	65W
	Power Certification	N/A
	Formfactor	N/A
	Type	ADAPTOR

In The Box	Keyboard Interface	N/A
	Mouse Interface	N/A
	Power Cord	1
	AC Adaptor	1
	Warranty Card	N/A
	Quick Guide	2
	User Manual	N/A
	VESA Mount kit	1
	Keyboard	N/A
	Mouse	N/A
Dimension & Weight	Product Dimension (WxDxH) (mm)	124 x 124 x 53.7
	Product Dimension (WxDxH) (inch)	4.88 x 4.88 x 2.11
	Inside Carton Dimension (WxDxH) (mm)	205 x 220 x 94
	Inside Carton Dimension (WxDxH) (inch)	8.07 x 8.66 x 3.7
	Outer Carton Dimension Standard (WxDxH) (mm)	221 x 506 x 469
	Outer Carton Dimension Standard (WxDxH) (inch)	8.7 x 19.92 x 18.46
	Weight (Net kg)	0.54
	Weight (Gross kg)	1.39
Warranty	Warranty	36months
Regulatory Compliance	Operating, Storage Temperature	0° C ~ 35° C ; -20° C ~ 60° C
	Operating, Storage Humidity	0% ~ 85%;0% ~ 90%
	Regulatory Compliance	FCC(Class B), CB/CE, UL(CUL), BSMI, VCCI, RCM(C-Tick)
VESA	VESA size	100 x 100 mm
Barcode Info	EAN	4711377071611