

## Be Your Window To The World



Picture and logos

### SELLING POINTS

- Windows 11 Famille- MSI recommande Windows 11 Professionnel pour les entreprises
- Processeur Intel Alder Lake
- Support de la résolution 4K UHD
- Supporte la connexion simultanée de trois écrans externes
- Deux connecteurs LAN pour une connexion internet et intranet
- Ports USB 3.2 Gen2 pour des transferts de données rapides et fluides
- Module dTPM 2.0 pour une bonne sécurité des données
- Support de la fixation VESA
- Support de MSI Cloud Center et MSI Center

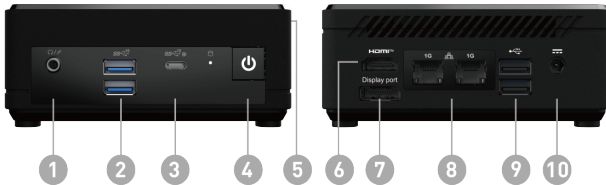

1. 1x Mic-in/ Headphone-out combo
2. 2x USB 3.2 Gen 2 Type A
3. 1x USB 3.2 Gen 2 Type C (DP Alternate)
4. 1x Power Button
5. 1x Kensington Lock
6. 1x HDMI™ (2.1)
7. 1x DP-out (1.4)
8. 2x RJ45 (LAN)
9. 2x USB 2.0 Type A
10. DC Jack

**SPECIFICATION**

Système d'exploitation	Operating Systems	Windows 11 Pro
Modèle	Part No	9S6-B0A921-248
	MKT Name	Cubi N ADL S
	MKT Spec	Cubi N ADL S-098EU
	Color	ID1/Black-Black-Black
	SKU Number	0
Chipset	Chipsets	Soc
Mémoire	Memory Size	4GB(4GB*1)
	Memory Type	DDR4 SDRAM
	Memory Speed	1600(3200)MHz
	Module Type	SO-DIMM
	Memory Slot(Total)	1
	Memory Slot(Free)	0
Processeur	Max Capacity	Max 16GB
	CPU Number	Intel Processor N200
	CPU Clock	1GHz
	CPU Cores	4
	TDP	6W
	Max Turbo Frequency	up to 3.70 GHz
	Cache	6 MB
Graphismes	Threads	4
	GPU1 Vendor	N/A
	GPU1 MKT Name	N/A
	GPU1 Number	N/A
Audio	GPU1 VRAM Size	N/A
	Audio Chipset	Realtek ALC256
Stockage	Audio Type	2.1 Channel HD Audio
	SSD Interface	PCIe GEN3x4
	SSD Form Factor	M.2-2280 M-KEY
	SSD Config	128GB*1
	SSD Size	128GB
	HDD1 Interface	N/A
	HDD1 Form Factor	N/A
	HDD1 Size	N/A
	HDD1 RPM	N/A
	ODD(Type)	N/A
	ODD Height	N/A
	ODD Type	N/A
	M.2 slots(Total)	1
	M.2 slots(Free)	0
2.5" Drive Bays (Free)	0	
3.5" Drive Bays(Free)	0	
Communication	LAN	2x Realtek RTL8111H
	WLAN Version	802.11ac 1x1+BT
	BT Version	5
Ports E/S (côté)	Mic-in/Headphone-out combo	1
	USB 3.2 Gen 2 (10G) Type C	1x USB 3.2 Gen 2 Type C (DisplayPort Alternate)
	USB 3.2 Gen 2 (10G) Type A	2
Ports E/S (arrière)	USB 2.0 Type A (R)	2
	RJ45	2
	HDMI out	1x (v2.1)
	DP out	1x (v1.4)
	Lock type	Kensington Lock
Garantie	Warranty	36months

Dimensions et poids	Weight (Net kg)	0.69
	Weight (Gross kg)	1.54
	Product Dimension (WxDxH) (mm)	124 x 124 x 53.7
	Product Dimension (WxDxH) (inch)	4.88 x 4.88 x 2.11
	Inside Carton Dimension (WxDxH) (mm)	205 x 220 x 94
	Inside Carton Dimension (WxDxH) (inch)	8.07 x 8.66 x 3.7
	Net Weight (lbs)	1.52
	Gross Weight (lbs)	3.4
VESA	VESA size	100 x 100 mm
Mécanique et environnement	Regulatory Compliance	FCC(Class B) CB/CE UL(CUL) BSMI VCCI RCM(C-Tick) Energy Star ERP lot 3 CEC RH
Accessoires	AC Adaptor	1
	Power Cord	1
	Warranty Card	N/A
	Quick Guide	2
	User Manual	N/A
	VESA Mount kit	1
	Keyboard	N/A
	Keyboard Interface	N/A
	Mouse	N/A
	Mouse Interface	N/A
Power Switch	N/A	
Code-barre	EAN	4711377216531
Security	TPM module	dTPM
	Chassis Lock	Kensington Lock