

Be Your Window To The World



Picture and logos

SELLING POINTS

- Windows 11 Famille- MSI recommande Windows 11 Professionnel pour les entreprises
- Processeur Intel Alder Lake
- Support de la résolution 4K UHD
- Supporte la connexion simultanée de trois écrans externes
- Deux connecteurs LAN pour une connexion internet et intranet
- Ports USB 3.2 Gen2 pour des transferts de données rapides et fluides
- Module dTPM 2.0 pour une bonne sécurité des données
- Support de la fixation VESA
- Support de MSI Cloud Center et MSI Center

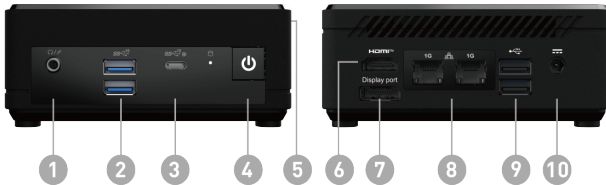

1. 1x Mic-in/ Headphone-out combo
2. 2x USB 3.2 Gen 2 Type A
3. 1x USB 3.2 Gen 2 Type C (DP Alternate)
4. 1x Power Button
5. 1x Kensington Lock
6. 1x HDMI™ (2.1)
7. 1x DP-out (1.4)
8. 2x RJ45 (LAN)
9. 2x USB 2.0 Type A
10. DC Jack

SPECIFICATION

Système d'exploitation	Operating Systems	Windows 11 Pro
Modèle	Part No	9S6-B0A911-227
	MKT Name	Cubi N ADL
	MKT Spec	Cubi N ADL-001EU
	Color	ID1/Black-Black-Black
	SKU Number	0
Chipset	Chipsets	Soc
Mémoire	Memory Size	4GB(4GB*1)
	Memory Type	DDR4 SDRAM
	Memory Speed	1600(3200)MHz
	Module Type	SO-DIMM
	Memory Slot(Total)	1
	Memory Slot(Free)	0
Processeur	Max Capacity	Max 16GB
	CPU Number	Intel Processor N200
	CPU Clock	1GHz
	CPU Cores	4
	TDP	6W
	Max Turbo Frequency	up to 3.70 GHz
	Cache	6 MB
Graphismes	Threads	4
	GPU1 Vendor	N/A
	GPU1 MKT Name	N/A
	GPU1 Number	N/A
Audio	GPU1 VRAM Size	N/A
	Audio Chipset	Realtek ALC256
Stockage	Audio Type	2.1 Channel HD Audio
	SSD Interface	PCIe GEN3x4
	SSD Form Factor	M.2-2280 M-KEY
	SSD Config	128GB*1
	SSD Size	128GB
	HDD1 Interface	N/A
	HDD1 Form Factor	N/A
	HDD1 Size	N/A
	HDD1 RPM	N/A
	ODD(Type)	N/A
	ODD Height	N/A
	ODD Type	N/A
	M.2 slots(Total)	1
	M.2 slots(Free)	0
Communication	2.5" Drive Bays(Total)	1
	2.5" Drive Bays (Free)	1
	3.5" Drive Bays(Free)	0
Ports E/S (côté)	LAN	2x Realtek RTL8111H
	WLAN Version	802.11ac 1x1+BT
	BT Version	5
Ports E/S (arrière)	USB 3.2 Gen 2 Type C	1x USB 3.2 Gen 2 Type C (DisplayPort Alternate)
	USB 3.2 Gen 2 Type A	2
	Mic-in/Headphone-out combo	1
	USB 3.2 Gen 2 (10G) Type C	1x USB 3.2 Gen 2 Type C (DisplayPort Alternate)
	USB 3.2 Gen 2 (10G) Type A	2
Garantie	USB 2.0 Type A (R)	2
	RJ45	2
	HDMI out	1x (v2.1)
	DP out	1x (v1.4)
Warranty		24months

Dimensions et poids	Weight (Net kg)	0.54
	Weight (Gross kg)	1.39
	Product Dimension (WxDxH) (mm)	124 x 124 x 53.7
	Product Dimension (WxDxH) (inch)	4.88 x 4.88 x 2.11
	Inside Carton Dimension (WxDxH) (mm)	205 x 220 x 94
	Inside Carton Dimension (WxDxH) (inch)	8.07 x 8.66 x 3.7
	Net Weight (lbs)	1.19
	Gross Weight (lbs)	3.06
VESA	VESA size	100 x 100 mm
Mécanique et environnement	Regulatory Compliance	FCC(Class B) CB/CE UL(CUL) BSMI VCCI RCM(C-Tick) Energy Star ERP lot 3 CEC RH
Accessoires	AC Adaptor	1
	Power Cord	1
	Warranty Card	N/A
	Quick Guide	2
	User Manual	N/A
	VESA Mount kit	1
	Keyboard	N/A
	Keyboard Interface	N/A
	Mouse	N/A
	Mouse Interface	N/A
Power Switch	N/A	
Code-barre	EAN	4711377069502
Security	TPM module	dTPM
	Chassis Lock	Kensington Lock