

Be Your Window To The World



Picture and logos

SELLING POINTS

- Windows 11 Famille- MSI recommande Windows 11 Professionnel pour les entreprises
- Processeur Intel Alder Lake
- Support de la résolution 4K UHD
- Supporte la connexion simultanée de trois écrans externes
- Deux connecteurs LAN pour une connexion internet et intranet
- Ports USB 3.2 Gen2 pour des transferts de données rapides et fluides
- Module dTPM 2.0 pour une bonne sécurité des données
- Support de la fixation VESA
- Support de MSI Cloud Center et MSI Center

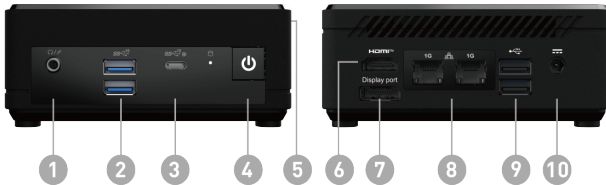

1. 1x Mic-in/ Headphone-out combo
2. 2x USB 3.2 Gen 2 Type A
3. 1x USB 3.2 Gen 2 Type C (DP Alternate)
4. 1x Power Button
5. 1x Kensington Lock
6. 1x HDMI™ (2.1)
7. 1x DP-out (1.4)
8. 2x RJ45 (LAN)
9. 2x USB 2.0 Type A
10. DC Jack

SPECIFICATION

| | | |
|------------------------|----------------------------|---|
| Système d'exploitation | Operating Systems | N/A |
| Modèle | Part No | 936-B0A911-031 |
| | MKT Name | Cubi N ADL |
| | MKT Spec | Cubi N ADL-009BEU |
| | Color | ID1/Black-Black-Black |
| Chipset | Chipsets | Soc |
| Mémoire | Memory Size | N/A |
| | Memory Type | N/A |
| | Memory Speed | N/A |
| | Module Type | SO-DIMM |
| | Memory Slot(Total) | 1 |
| | Memory Slot(Free) | 1 |
| | Max Capacity | Max 16GB |
| Processeur | CPU Number | Intel Processor N100 |
| | CPU Clock | 0.8GHz |
| | CPU Cores | 4 |
| | TDP | 6W |
| | Max Turbo Frequency | up to 3.40 GHz |
| | Cache | 6 MB |
| | Threads | 4 |
| Graphismes | GPU1 Vendor | N/A |
| | GPU1 MKT Name | N/A |
| | GPU1 Number | N/A |
| | GPU1 VRAM Size | N/A |
| Audio | Audio Chipset | Realtek ALC256 |
| | Audio Type | 2.1 Channel HD Audio |
| Stockage | SSD Interface | N/A |
| | SSD Form Factor | N/A |
| | SSD Config | N/A |
| | SSD Size | N/A |
| | HDD1 Interface | N/A |
| | HDD1 Form Factor | N/A |
| | HDD1 Size | N/A |
| | HDD1 RPM | N/A |
| | ODD(Type) | N/A |
| | ODD Height | N/A |
| | ODD Type | N/A |
| | M.2 slots(Total) | 1 |
| | M.2 slots(Free) | 1 |
| | 2.5" Drive Bays(Total) | 1 |
| | 2.5" Drive Bays (Free) | 1 |
| 3.5" Drive Bays(Free) | 0 | |
| Communication | LAN | 2x Realtek RTL8111H |
| | WLAN Version | 802.11ac 1x1+BT |
| | BT Version | 5 |
| Ports E/S (côté) | USB 3.2 Gen 2 Type C | 1x USB 3.2 Gen 2 Type C (DisplayPort Alternate) |
| | USB 3.2 Gen 2 Type A | 2 |
| | Mic-in/Headphone-out combo | 1 |
| | USB 3.2 Gen 2 (10G) Type C | 1x USB 3.2 Gen 2 Type C (DisplayPort Alternate) |
| | USB 3.2 Gen 2 (10G) Type A | 2 |
| Ports E/S (arrière) | USB 2.0 Type A (R) | 2 |
| | RJ45 | 2 |
| | HDMI out | 1x (v2.1) |
| | DP out | 1x (v1.4) |
| Garantie | Warranty | 36months |

| | | |
|----------------------------|--|--|
| Dimensions et poids | Weight (Net kg) | 0.54 |
| | Weight (Gross kg) | 1.39 |
| | Product Dimension (WxDxH) (mm) | 124 x 124 x 53.7 |
| | Product Dimension (WxDxH) (inch) | 4.88 x 4.88 x 2.11 |
| | Inside Carton Dimension (WxDxH) (mm) | 205 x 220 x 94 |
| | Inside Carton Dimension (WxDxH) (inch) | 8.07 x 8.66 x 3.7 |
| | Net Weight (lbs) | 1.19 |
| | Gross Weight (lbs) | 3.06 |
| VESA | VESA size | 100 x 100 mm |
| Mécanique et environnement | Regulatory Compliance | FCC(Class B) CB/CE UL(CUL) BSMI VCCI RCM(C-Tick) Energy Star ERP lot 3 CEC RH |
| Accessoires | AC Adaptor | 1 |
| | Power Cord | 1 |
| | Warranty Card | N/A |
| | Quick Guide | 2 |
| | User Manual | N/A |
| | VESA Mount kit | 1 |
| | Keyboard | N/A |
| | Keyboard Interface | N/A |
| | Mouse | N/A |
| Mouse Interface | N/A | |
| Code-barre | EAN | 4711377071611 |
| Security | TPM module | dTPM |
| | Chassis Lock | Kensington Lock |