

Be Your Window To The World



Picture and logos

SELLING POINTS

- Windows 11 Home - MSI raccomanda Windows 11 Pro per il mondo Business
- Processori Intel Alder Lake
- Supporto display con risoluzione 4K
- Supporta fino a tre monitor contemporaneamente
- Doppia connettività internet e intranet
- Porte USB 3.2 Gen 2 con la massima velocità di trasferimento dati
- Massima sicurezza con il modulo dTPM 2
- Attacco VESA
- Software MSI Cloud Center e MSI Center

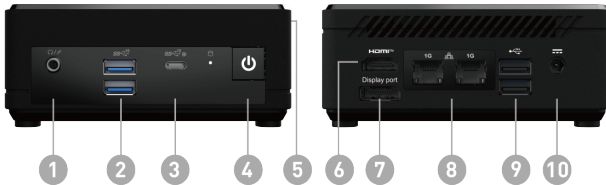

1. 1x Mic-in/ Headphone-out combo
2. 2x USB 3.2 Gen 2 Type A
3. 1x USB 3.2 Gen 2 Type C (DP Alternate)
4. 1x Power Button
5. 1x Kensington Lock
6. 1x HDMI™ (2.1)
7. 1x DP-out (1.4)
8. 2x RJ45 (LAN)
9. 2x USB 2.0 Type A
10. DC Jack

SPECIFICATION

Operating Systems	Operating Systems	Windows 11 Pro
Processor	CPU Number	Intel Processor N100
	CPU Clock	0.8GHz
	CPU Cores	4
	TDP	6W
	Cache	6 MB
	Threads	4
	Max Turbo Frequency	up to 3.40 GHz
	CPU Cooler	Fanless
	Platform TOPS	N/A
	NPU TOPS	N/A
Model	Part No	9S6-B0A921-288
	MKT Name	Cubi N ADL S
	MKT Spec	Cubi N ADL S-288EU
	Color	ID1/Black-Black-Black
	SKU Number	0
Chipset	Model	B0A9
Memory	Chipsets	Soc
	Memory Size	8GB(8GB*1)
	Memory Type	DDR4 SDRAM
	Memory Speed	1600(3200)MHz
	Module Type	SO-DIMM
	Memory Slot(Total)	1
	Memory Slot(Free)	0
	Max Capacity	Max 16GB
Discrete Graphics	Memory Slot (Total/Free)	1/0
	GPU1 VRAM Size	N/A
	VGA I/O Port	N/A
	GPU1 Vendor	N/A
	GPU1 MKT Name	N/A
Storage	GPU1 Number	N/A
	SSD Interface	PCIe GEN3x4
	SSD Form Factor	M.2-2280 M-KEY
	SSD Config	128GB*1
	SSD Size	128GB
	HDD1 Interface	N/A
	HDD1 Form Factor	N/A
	HDD1 Size	N/A
	HDD1 RPM	N/A
	ODD(Type)	N/A
	ODD Height	N/A
	ODD Type	N/A
	M.2 slots (Total/Free)	1/0
	2.5" Drive Bays (Total/Free)	0/
	3.5" Drive Bays (Total/Free)	0/
	M.2 slots(Total)	1
M.2 slots(Free)	0	
2.5" Drive Bays (Free)	0	
3.5" Drive Bays(Free)	0	
Audio	Audio Chipset	Realtek ALC256
	Audio Type	2.1 Channel HD Audio
	D-MIC	N/A
Communications	LAN	2x Realtek RTL8111H
	WLAN Version	Wi-Fi 5+BT
	BT Version	5
	WLAN	AzureWave/AW-CB515NF



Cubi N ADL

CUBI N ADL S-288EU

I/O Ports (Front)	Mic-in/Headphone-out combo	1
	USB 3.2 Gen 2 (10G) Type C	1x USB 3.2 Gen 2 Type C (DisplayPort Alternate)
	USB 3.2 Gen 2 (10G) Type A	2
	USB 4 (40G) Type C	N/A
	Copilot Button	N/A
I/O Ports (Rear)	USB 2.0 Type A (R)	2
	RJ45	2
	HDMI out	1x (v2.1)
	DP out	1x (v1.4)
	Lock type	Kensington Lock
	USB 4 (40G) Type C (R)	N/A
	Configurable port	N/A
I/O Ports (Side)	Mic-in/Headphone-out combo	1
	USB 3.2 Gen 2 (10G) Type C	1x USB 3.2 Gen 2 Type C (DisplayPort Alternate)
	USB 3.2 Gen 2 (10G) Type A	2
Power	Power	65W
	Power Certification	N/A
	Formfactor	N/A
	Type	ADAPTOR
VESA	VESA size	100 x 100 mm
Warranty	Warranty	36months
Dimension & Weight	Product Dimension (WxDxH) (mm)	124 x 124 x 53.7
	Product Dimension (WxDxH) (inch)	4.88 x 4.88 x 2.11
	Inside Carton Dimension (WxDxH) (mm)	205 x 220 x 94
	Inside Carton Dimension (WxDxH) (inch)	8.07 x 8.66 x 3.7
	Outer Carton Dimension Standard (WxDxH) (mm)	221 x 506 x 469
	Outer Carton Dimension Standard (WxDxH) (inch)	8.7 x 19.92 x 18.46
	Weight (Net kg)	0.69
	Net Weight (lbs)	1.52
	Weight (Gross kg)	1.54
	Gross Weight (lbs)	3.4
	Liter	0.7L
Pint	0.7L	
Regulatory Compliance	Regulatory Compliance	BSMI, CB/CE, CEC, ERP lot 3, Energy Star, FCC(Class B), RCM(C-Tick), RH, UL(CUL), VCCI
	Operating, Storage Temperature	0° C ~ 35° C ; -20° C ~ 60° C
	Operating, Storage Humidity	0% ~ 85%;0% ~ 90%
In The Box	AC Adaptor	1
	Power Cord	1
	Warranty Card	N/A
	Quick Guide	2
	User Manual	N/A
	VESA Mount kit	1
	Keyboard	N/A
	Keyboard Interface	N/A
	Mouse	N/A
	Mouse Interface	N/A
Power Switch	N/A	
Barcode Info	EAN	4711377425124
Security	TPM module	dTPM
	Chassis Lock	Kensington Lock